



AIR PURIFIER
User Manual
Model: GMCAP70



CONTENTS

| | |
|--------------------------------------|--------------|
| IMPORTANT NOTES | 3 |
| SAFETY INSTRUCTIONS | 4,5 |
| COMPONENTS | 6,7 |
| INSTALLATION | 8 |
| OPERATING INSTRUCTIONS | 9,10 |
| MAINTENANCE | 11 |
| SPECIFICATIONS/FEATURES | 12,13 |
| TROUBLESHOOTING | 14,15 |
| SERVICE AND WARRANTY | 16 |

IMPORTANT NOTES

N.B PLEASE REMOVE THE PLASTIC FROM THE INTERNAL FILTER BEFORE USING THE MACHINE.

Dear Customer

Your new GMC Air Purifier has been manufactured in a state-of-the-art facility and has passed the strictest quality control procedures. Please read this manual carefully before using your appliance for the first time and then please store this manual in a safe place for future reference.

Thank you again for choosing GMC.

If you have any issues at all with your product or any questions then the quickest route for resolution is to please contact us through our website www.gmcaircon.co.za or on 012-661-1173.

We will be able to resolve any issues that may arise and our technical team is always on hand for assistance. We pride ourselves on 100% customer satisfaction and we trust you will enjoy your new product.

Record in the space below the listed information for future reference.

SERIAL NUMBER.....

DATE OF PURCHASE.....

PURCHASED FROM.....

.....



Do not attempt to maintain the appliance yourself. Only authorised agents are to carry out repairs.

IMPORTANT! PLEASE REMOVE THE PLASTIC FROM THE INTERNAL FILTER BEFORE USING THE AIR PURIFIER.

Safety instructions

- Check the power of DC 5V 2A before use.
- Check the power supply unit and the power cable before plugging them in.
- When not in use, unplug the AC adapter from the wall outlet.
- Do not insert any objects into the air inlets and outlets of the unit. It may cause a short circuit. Special care must be taken when operating the device within the reach of children.
- Use the mains and/or power switch to switch the unit "on and off".
- Never use the power supply unit/line to switch the unit "on and off".
- Before changing the device, switch it off and unplug the power supply unit from the socket.
- Never attempt to clean the air inlets or outlets with sharp objects.
- Never immerse the appliance in water.
- Never spray flammable liquids into the device.
- Never operate the appliance in a damp room (e.g. bathroom). Risk of electric shock or power transfer.
- Never use hairsprays, thinners or flammable gases in the vicinity of the device, as there is a risk of fire and explosion.
- If candles or gas ovens burn in the same room during operation, open the window occasionally.
- Never cover the air inlet or outlet and keep away any moving textiles that may block the air inlet or outlet. This can damage/destroy the blower motor.
- When handling the appliance, make sure that your hair or clothing does not get into the air outlet. These could be detected by the fan wheel.
- Always position the device on a flat, horizontal and dry surface.
- Never operate the device near heat sources such as heaters, open fires or direct sunlight. The plastic parts can be deformed.

- The unit does not serve as a fan replacement. This considerably shortens the service life of the filter.
- The device must not be used in an environment containing high levels of dust or chlorine.
- Do not place heavy objects on the unit and keep it out of the reach of children.
- The device must not be used in closed, narrow or excessively warm rooms.
- Make sure that the mains cable is not pinched, excessively bent or twisted, as otherwise the cable wire can be exposed and/or damaged.
- If the mains cable is damaged, stop operation and replace it immediately.
- Only use the power supply included in the scope of delivery. Do not use a power supply unit from another device.
- Do not use the included power supply for other devices.
- If the device is defective, switch off the mains switch and disconnect it.
- To avoid interference, do not operate the equipment near microwaves or television sets.
- The device may only be operated by persons who are physically and mentally capable of correct operation in accordance with these operating instructions, or who have been instructed on this device by a responsible person.
- Never switch the appliance on or off with wet hands.
- Do not attempt to repair or make any other adjustments, both electrical and mechanical, to the unit yourself.
- Do not let children play with the packaging, such as plastic films.
- Ensure a minimum distance of 20 cm between the unit and the nearest wall.

COMPONENTS

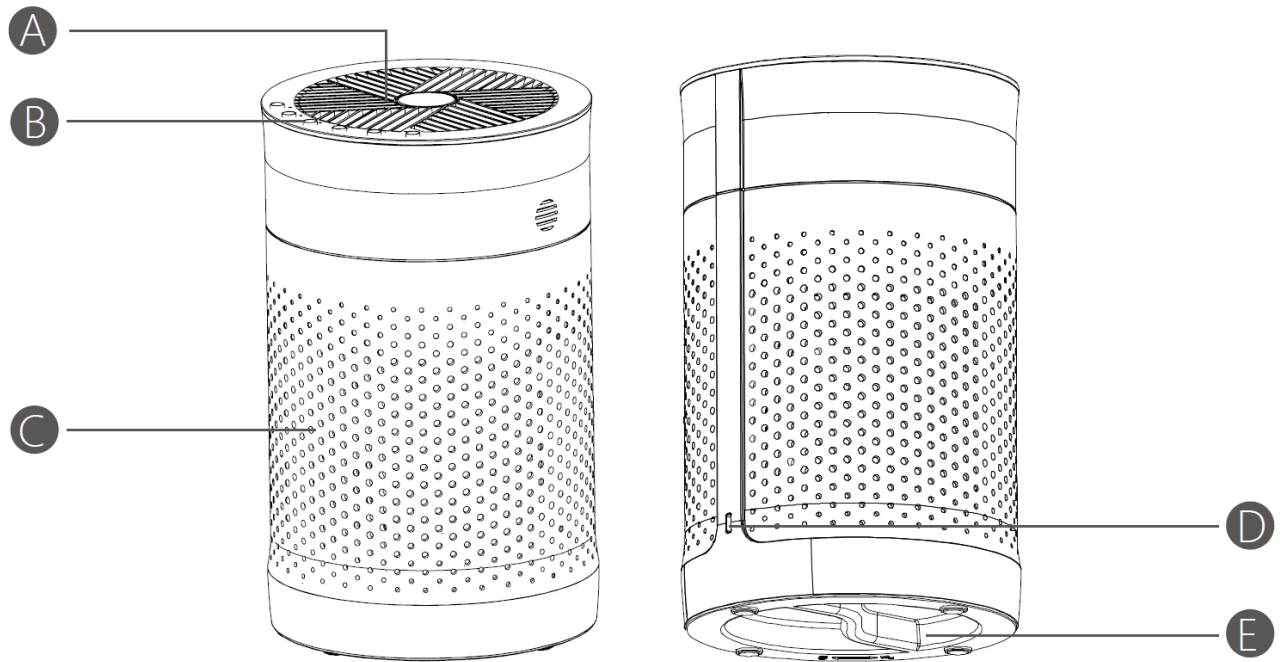

A. Air Outlet

B. Control Panel

C. Air Inlet

D. Type C Charger

E. Base

HEPA FILTER COMPONENTS

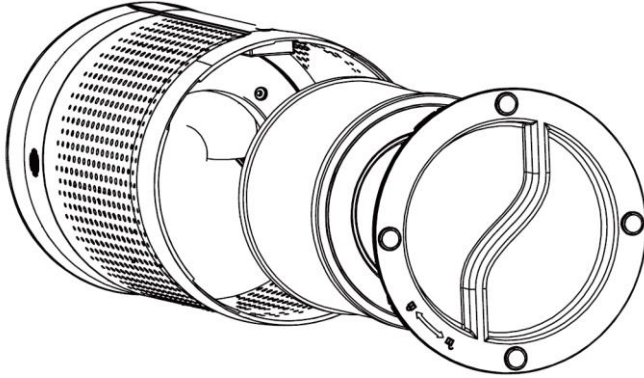

ACTIVATED CARBON AND HEPA COMPOSITE FILTER

This advanced filtration system effectively captures large particles such as dust, hair, PM2.5, allergens, and bacteria. It eliminates odors and purifies airborne pollutants, ensuring a healthier environment and providing fresh, clean air to protect both your health and the well-being of those around you

- Anaphylatoxins
- Bacteria/Viruses
- Fine Particles (PM2.5)
- Odors
- Pollen
- Second-hand Smoke
- Volatile Organic Compounds (VOCs)

INSTALLATION

Choose a room that needs to be purified and place the purifier on a flat floor or table. Before first use, please confirm that the filter bag inside the machine has been removed. Please also confirm:

- The air inlets and outlets are completely unobstructed;
- The filter screen and the bottom cover are correctly installed (see below);
- If the bottom cover is not properly installed, this device will not work properly.



Press the power button to turn off the machine, and unplug the power cord.

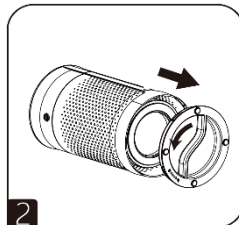

Rotate the bottom cover to the left, open the lock and remove the bottom cover

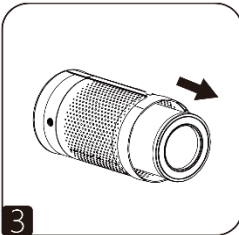

Remove the filter screen

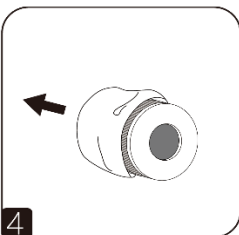

Remove plastic bag from new filter

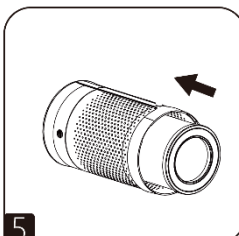

Put the filter back into machine

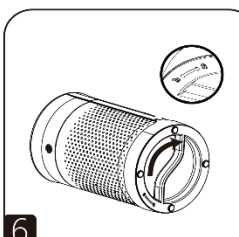

**Put the bottom shell back in place and rotate to the right
Lock the arrow and align it for normal use of the machine.**

OPERATING INSTRUCTIONS

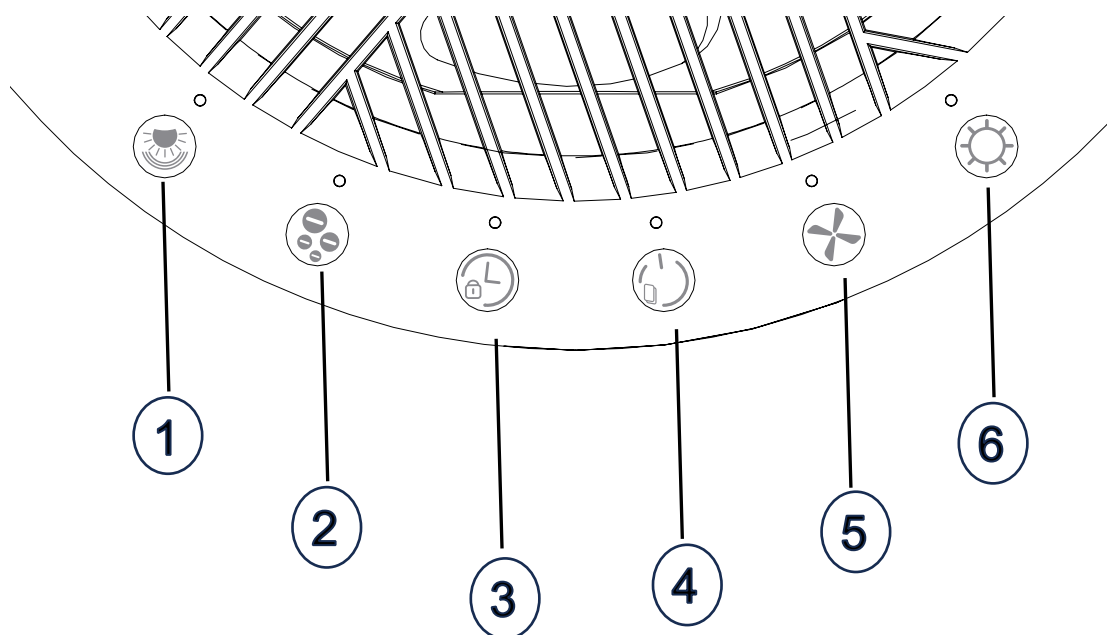

1. UVC

2. Anion

3. Timer / Child Lock

4. Power Switch / Filter Reset

5. Fan Speed

6. Light



Power Switch / Filter Reset

a) The device is powered by Type C. After connecting to the power source, the device enters standby mode. Press the switch button to turn on the device; the power indicator light will turn blue, defaulting to setting 2, with the night light on and the gear button light also turning blue. The anion function is activated, and the negative ion indicator light will turn on. Press the power button again to turn off the device and return it to standby mode.

b) When the service life of the machine filter expires, this button will flash red, prompting to replace the filter; Disconnect the device and replace with a new filter. After the filter is replaced, long press the button for 3s to turn off the red light to reset the filter life.



UVC

Touch the UVC button to activate the UVC function. When enabled, the built-in ultraviolet (UVC) LEDs operate to help neutralise bacteria and viruses present in the filter and passing airflow. Touch the UVC button again to deactivate the function.



Anion function

The negative ion is turned on by default when the machine is turned on, and the blue light of the negative ion button is lit; press the negative ion button to turn off the negative ion, and the negative ion button light is turned off.



Timer function/Child lock

a) The timer button can be set for 1-3 hour. The timer button lights up green for 1 hour; the timer button lights up blue for 2 hours. The timer button light is red when the timer is set for 3 hours, and the timer button light is off when the timer is canceled. The timer button light shows the remaining timer time.

b) Long press the timer button to open the child lock mode, other button functions are invalid. Press and hold the timer button again to close the child lock mode, and the button function returns to normal.



Fan speed

In the working state, the fan speed button can be switched between 1, 2 and 3 by pressing the fan speed button. When the fan speed button is at 1, the green light of the fan speed button is on; when the fan speed button is at 2, the blue light of the fan speed button is on; when the fan speed button is at 3, the red light of the fan speed button is on.



Lighting function

The night light is on by default when the machine is turned on. The night light can be turned off or on by pressing the light button. When the night light is off, the light button light is off; when the night light is on, the light button lights up with blue light

Maintenance

Filter change

Filter changes typically occur every 6 to 12 months, depending on usage and air quality. The unit includes a filter replacement indicator to notify you when it's time.

Filter change indicator:



Power Switch / Filter Reset

b) When the service life of the machine filter expires, this button will flash red, prompting to replace the filter; Disconnect the device and replace with a new filter. After the filter is replaced, long press the button for 3s to turn off the red light to reset the filter life.

Change the filter:

Switch and disconnect the device for this purpose. Put it upside down and open the filter cover at the bottom of the unit and remove the filter.

Please note that the replacement filter must be removed from the protective film before it can be inserted into the device. Finally, the filter must be locked again.

Cleaning the device

Always disconnect the power supply from the socket before cleaning!

Clean the appliance with a dry cloth. Do not use chemicals. You can also clean the air inlets with a vacuum cleaner (it is best to clean the unit outdoors).

Specifications

| | | | |
|-------------------------|---------------------|--------------------|------------------------------------|
| Product name | Air Purifier | Model | GMCAP70 |
| Rated voltage/frequency | 5V | Product size | 165mm(L) x 165mm(W) x 270mm (H) |
| Power | 5W | Net weight | 1.0kg |
| Decibel Rating | 28-52dB(A) | Applicable area | 15 m ² |
| CADR | 70m ³ /h | Fuselage materials | ABS |

FEATURES

- Application area: 15 m²
- CADR: 70m³/h
- Child lock
- DC 5V, 5W
- DC motor, extra quiet operation
- Fan speed: 3 fan speeds, high-med-low with 3 colors
- Filter replacement indicator
- HEPA13 filter removes 99.97% of particles
- UVC
- Negative ion, ionizer: 3,000,000 pcs/cm³
- Night light function
- Pre-filter, anti-bacteria ion filter, HEPA 13 filter, activated carbon filter (4-stage filter)
- Suitable for car & small office
- Timer: 3h
- Touch control panel
- USB cable with type-C

TROUBLE SHOOTING

| Phenomenon | Reason & Solution |
|---|---|
| The airflow that comes out of the air outlet is significantly weaker than before. | The surface of the filter is dirty. Clean the surface of the filter (see the cleaning instructions for filter). |
| The air quality does not improve, even though the appliance has been operating for a long time. | <ul style="list-style-type: none"> • Check if the packing material is removed from the filter. • Make sure that the filter is properly installed. • The air quality sensor is dirty or wet. Clean the air quality sensor • Room size is large or the outdoor air quality is poor. For optimum purification performance, please close the doors and fanows when operating the air purifier. • There are indoor pollution resources. For instances, smoking, cooking, incense. • Filter reaches the end of life. Replace the filter with a new one. |
| The appliance produces a strange smell. | <p>Please ensure you have removed the plastic over the HEPA filter. The first few times you use the appliance, it may produce a plastic smell. This is normal. However, if the appliance produces a burnt smell even if removing the filter, contact us at www.gmcaircon.com or 012-661-1173.</p> <p>The filter may produce smell after being used for a while because of the absorption of indoor gases. It's recommended that you reactivate the filter by putting it in direct sunlight for repeated use. If odor still exists, replace the filter.</p> |
| Three gear indicator lights up at the same time | There is a machine malfunction. Please cut off the power immediately and contact us on 012-661-1173 or www.gmcaircon.com |
| E1 | Please ensure all sensors have been cleaned on the air |

| | |
|---|--|
| | purifier. If the problem still persists please contact us on 012-661-1173 or www.gmcaircon.com |
| The appliance is extra loud. | <ul style="list-style-type: none"> • Check if the packing of the filter is removed. • The appliance will run in high speed when the air quality is poor, which will cause higher noises. When using the appliance in a bedroom at night, choose the Sleep speed. • if anything drops into air outlet, it may also cause abnormal loud sounds. Immediate turn off appliance, turn appliance upside down, to get foreign objectives out of appliance. |
| The appliance still indicates that I need to replace a filter, but I already did. | Perhaps you did not reset the filter lifetime counter. Switch on the appliance. If the filter has been replaced, the filter change indicator must be reset again. long press the POWER button for 5 seconds to reset the air purifier. |

SERVICE AND WARRANTY

GMC Airconditioning(Pty) Ltd. was established in 1995 and is one of South Africa's leading cooling and heating companies. We pride ourselves on 100% customer satisfaction and have the highest online rating of all heating and cooling companies in South Africa. We will strive to ensure you are 100% satisfied with your product.

In the rare case of encountering any issues with your product or would like some support please contact us directly on 012-661-1173 or www.gmcaircon.co.za as this will allow us to react quickly to your request. If you have bought this product from one of our partner platforms, then contacting us directly will allow us to resolve the issue for you in a timelier fashion.

We are here to help you and ensure you are 100% satisfied.

Please read this instruction manual carefully before setting up or using this product. If you believe this product to be suffering from a manufacturing fault, or if you have any inquiries about this product, please contact our customer support.

CUSTOMER SUPPORT

GMC Airconditioning(Pty) Ltd.

**35 Sarel Baard Crescent
Gateway Industrial Park
Centurion
0046
Telephone:** +27 (12) 661-1173
Website: www.gmcaircon.co.za
Email: info@gmcaircon.com

When contacting our customer support, please have the information below available. All warranty requests must be accompanied by a proof of purchase, which is a copy of the original receipt.

Model:
Date of purchase:
Purchased from: