



**AIR PURIFIER**  
**User Manual**  
**Model: GMCAP300**



# CONTENTS

<b>IMPORTANT NOTES .....</b>	<b>3</b>
<b>SAFETY INSTRUCTIONS .....</b>	<b>4,5</b>
<b>COMPONENTS .....</b>	<b>6,7</b>
<b>INSTALLATION .....</b>	<b>8</b>
<b>OPERATING INSTRUCTIONS .....</b>	<b>9,10</b>
<b>WIFI INSTRUCTIONS.....</b>	<b>11,12,13,14</b>
<b>MAINTENANCE .....</b>	<b>15,16</b>
<b>SPECIFICATIONS/FEATURES .....</b>	<b>17,18</b>
<b>TROUBLESHOOTING .....</b>	<b>19,20</b>
<b>SERVICE AND WARRANTY .....</b>	<b>21</b>

## IMPORTANT NOTES

### **N.B PLEASE REMOVE THE PLASTIC FROM THE INTERNAL FILTER BEFORE USING THE MACHINE.**

Dear Customer

Your new GMC Air Purifier has been manufactured in a state-of-the-art facility and has passed the strictest quality control procedures. Please read this manual carefully before using your appliance for the first time and then please store this manual in a safe place for future reference.

Thank you again for choosing GMC.

If you have any issues at all with your product or any questions then the quickest route for resolution is to please contact us through our website [www.gmcaircon.co.za](http://www.gmcaircon.co.za) or on 012-661-1173.

We will be able to resolve any issues that may arise and our technical team is always on hand for assistance. We pride ourselves on 100% customer satisfaction and we trust you will enjoy your new product.

Record in the space below the listed information for future reference.

SERIAL NUMBER.....

DATE OF PURCHASE.....

PURCHASED FROM.....

.....



Do not attempt to maintain the appliance yourself. Only authorised agents are to carry out repairs.

**IMPORTANT! PLEASE REMOVE THE PLASTIC FROM THE INTERNAL FILTER BEFORE USING THE AIR PURIFIER.**

# Safety instructions

- Check the voltage of 220-240V~ 50-60Hz before use.
- Check the power supply unit and the power cable before plugging them in.
- When not in use, unplug the AC adapter from the wall outlet.
- Do not insert any objects into the air inlets and outlets of the unit. It may cause a short circuit. Special care must be taken when operating the device within the reach of children.
- Use the mains and/or power switch to switch the unit "on and off".
- Never use the power supply unit/line to switch the unit "on and off".
- Before changing the device, switch it off and unplug the power supply unit from the socket.
- Never attempt to clean the air inlets or outlets with sharp objects.
- Never immerse the appliance in water.
- Never spray flammable liquids into the device.
- Never operate the appliance in a damp room (e.g. bathroom). Risk of electric shock or power transfer.
- Never use hairsprays, thinners or flammable gases in the vicinity of the device, as there is a risk of fire and explosion.
- If candles or gas ovens burn in the same room during operation, open the window occasionally.
- Never cover the air inlet or outlet and keep away any moving textiles that may block the air inlet or outlet. This can damage/destroy the blower motor.
- When handling the appliance, make sure that your hair or clothing does not get into the air outlet. These could be detected by the fan wheel.
- Always position the device on a flat, horizontal and dry surface.

- Never operate the device near heat sources such as heaters, open fires or direct sunlight. The plastic parts can be deformed.
- The unit does not serve as a fan replacement. This considerably shortens the service life of the filter.
- The device must not be used in an environment containing high levels of dust or chlorine.
- Do not place heavy objects on the unit and keep it out of the reach of children.
- The device must not be used in closed, narrow or excessively warm rooms.
- Make sure that the mains cable is not pinched, excessively bent or twisted, as otherwise the cable wire can be exposed and/or damaged.
- If the mains cable is damaged, stop operation and replace it immediately.
- Only use the power supply included in the scope of delivery. Do not use a power supply unit from another device.
- Do not use the included power supply for other devices.
- If the device is defective, switch off the mains switch and disconnect it.
- To avoid interference, do not operate the equipment near microwaves or television sets.
- The device may only be operated by persons who are physically and mentally capable of correct operation in accordance with these operating instructions, or who have been instructed on this device by a responsible person.
- Never switch the appliance on or off with wet hands.
- Do not attempt to repair or make any other adjustments, both electrical and mechanical, to the unit yourself.
- Do not let children play with the packaging, such as plastic films.
- Ensure a minimum distance of 20 cm between the unit and the nearest wall.

# COMPONENTS

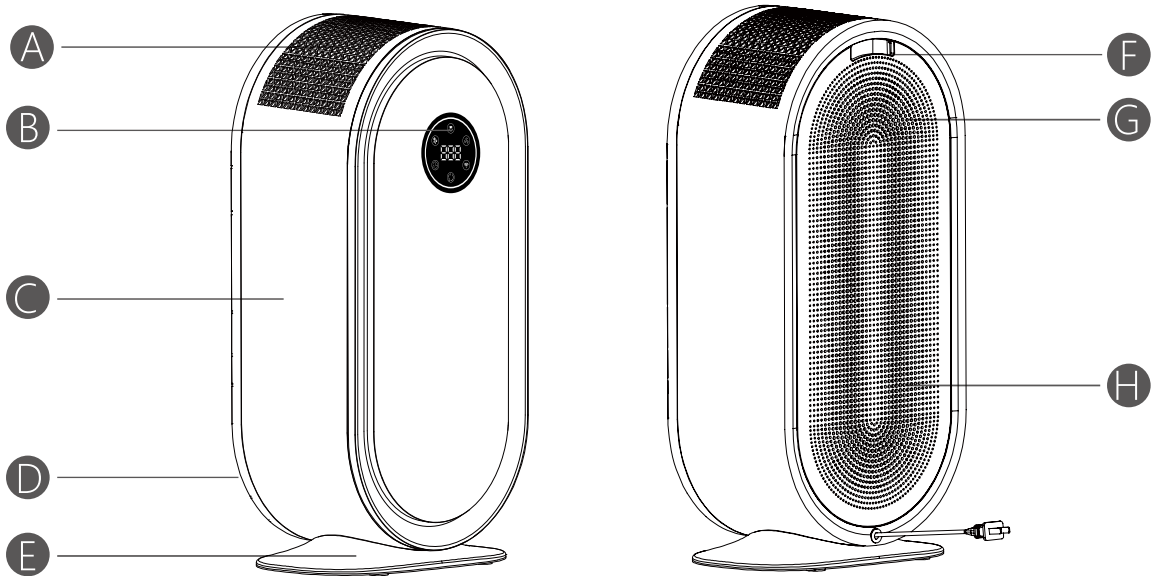

## Product description

- Ⓐ Air outlet network   Ⓑ Control panel   Ⓒ Fuselage   Ⓓ Power Line   Ⓔ Base  
Ⓕ Rear Shell   Ⓖ Sensor   Ⓗ Ventilation network

# HEPA FILTER COMPONENTS

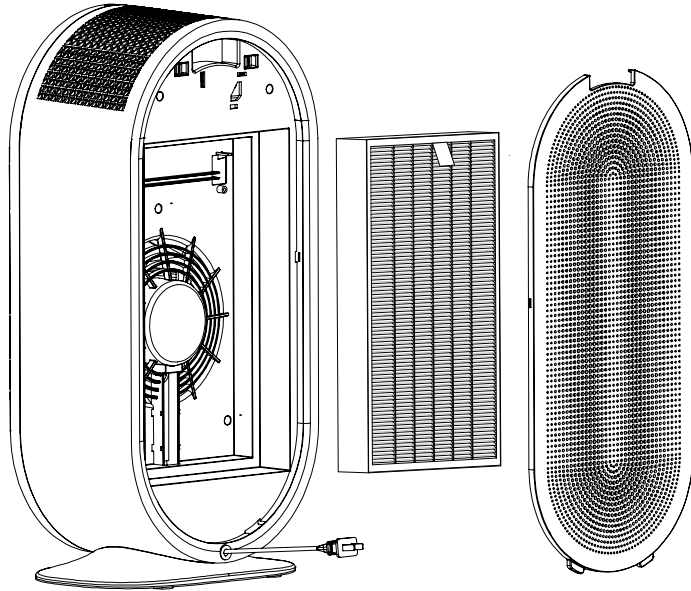

## ACTIVATED CARBON AND HEPA COMPOSITE FILTER

This advanced filtration system effectively captures large particles such as dust, hair, PM2.5, allergens, and bacteria. It eliminates odors and purifies airborne pollutants, ensuring a healthier environment and providing fresh, clean air to protect both your health and the well-being of those around you

- Anaphylatoxins
- Bacteria/Viruses
- Fine Particles (PM2.5)
- Odors
- Pollen
- Second-hand Smoke
- Volatile Organic Compounds (VOCs)

# INSTALLATION

## **BEFORE USE :**

- Select the room where you need to purify the air and place the purifier on a stable floor or countertop in the room.
- In order to allow free circulation of air, avoid placing the purifier behind the curtains, under the window, next to the furniture or shelves, and near any obstacles. Keep at least 50 cm of free space on each side of the purifier.
- Please confirm that the filter bag inside the machine has been removed before initial use.

## **PLEASE CONFIRM:**

- The voltage of your home matches the voltage of the device identification.
- Your device can be connected to a grounded power plug. This device is a Class II appliance (double insulated).
- The air inlet and outlet are completely unobstructed.
- The filter and the rear casing are properly installed (see below).
- If the front door is not properly installed, the unit will not work properly.
- The first time you use the filter to remove the filter and the filter is replaced after the life of the filter expires (Figure 1-6)

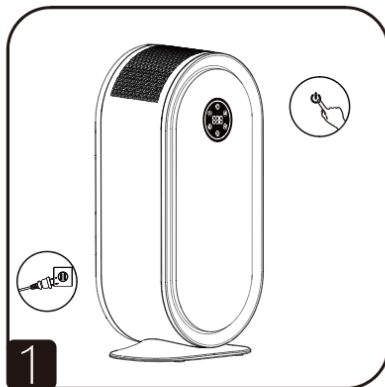

Press the power button to turn off the power and turn off the power.

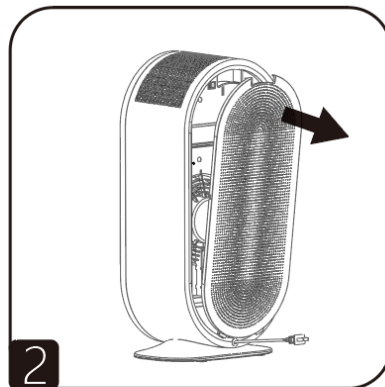

Use your hand to remove the rear case from the buckle.

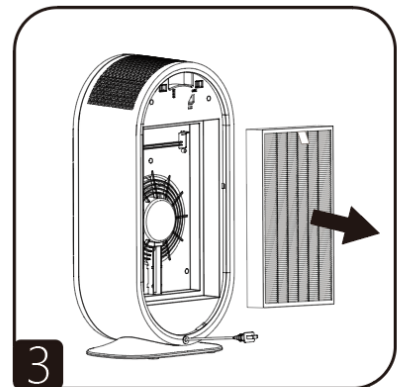

Remove the filter.

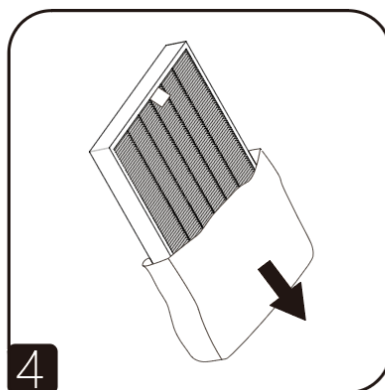

Remove the plastic bag from the new filter.

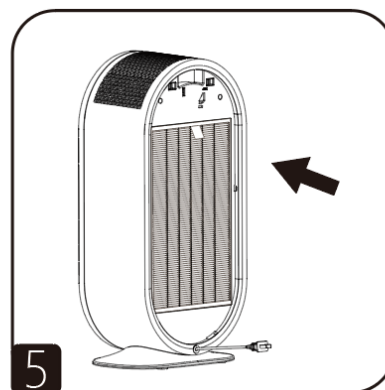

Replace the filter that removes the bag.

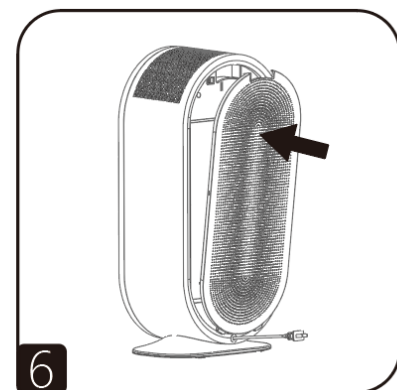

Put the back shell back in its original position to ensure it is in place. The machine can be used normally.

# OPERATING INSTRUCTIONS

## CONTROL PANEL

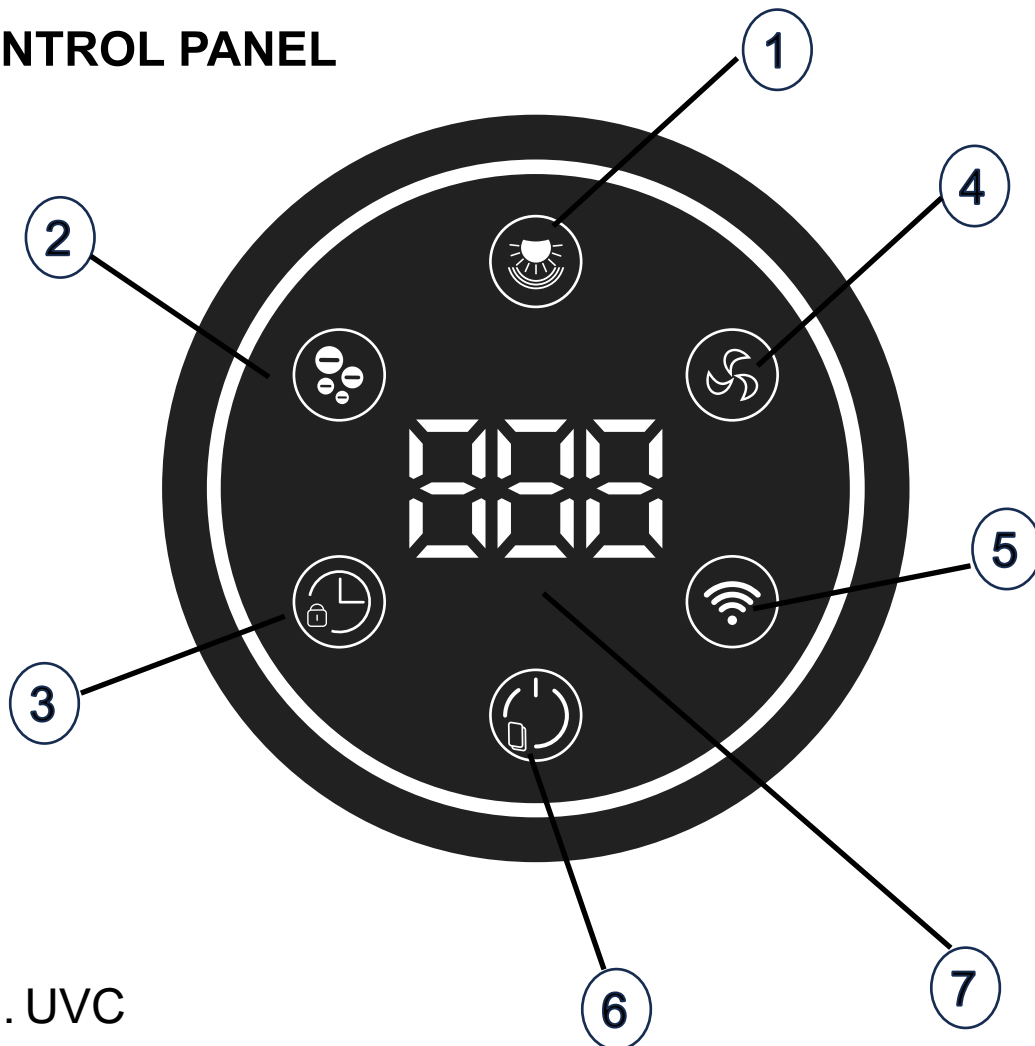

1. UVC

2. Anion

3. Timer Function/Child lock

4. Fan speed/Sleep mode/Auto mode

5. WIFI

6. Power Switch / Filter Reset

7. Digital display



## Power Switch / Filter Reset

a) Turn the purifier on or off. Press to turn on air purifier. The device defaults to operating in Auto mode, the sensor undergoes a 30-second preheating period, the operation panel digital frame flashes about 30S, the air quality detection sensor system completes the test. The indoor air quality condition is informed by the digital display of the operation panel and the air quality indicator "green, blue and red";

Digital Display	Color	air quality
1-75	Green	Very good
76-150	Blue	good
Over 150	Red	poor

b) When the service life of the machine filter expires, this button will flash red, prompting to replace the filter; Disconnect the device and replace with a new filter. After the filter is replaced, long press the button for 3s to turn off the red light to reset the filter life.



## WIFI

Press this button 3s to connect with wifi. Please read the WIFI section of the user manual



## Timer Function / Child Lock

a) When the purifier is working, press the button to select the required working time (1~8h). After the set time, the purifier will automatically stop working.

b) Press this button for 3s to lock the device, press this button for 3s again to unlock the device.



## Fan speed/Sleep mode/Auto model

The user can set the fan speed according to the actual demand, touch this key, fan speed will adjust by low-mid-high-auto-sleep.

In Auto mode, the fan speed and the color of the air quality light will be adjusted and changed in real time according to the degree of air pollution.

In Sleep mode, all the light will be off and the wind speed will be at low gear.



## UVC

Touch the UVC button to activate the UVC function. When enabled, the built-in ultraviolet (UVC) lamp operates to help neutralise bacteria and viruses present in the filter and passing airflow. Touch the UVC button again to deactivate the function.



## Anion

Touch the anion button to turn on the anion function. The built-in anion generator starts to release the anion. Touch the anion button again to turn off.

## WIFI SETUP INSTRUCTIONS

### 1. Download and Install the Tuya Smart Life App:

- Locate and download the "Tuya Smart Life" app from either the Apple App Store or Google Play Store.
- Alternatively, scan the QR code below to access the app.



### 2. Register on the App

- Follow the registration process within the app.

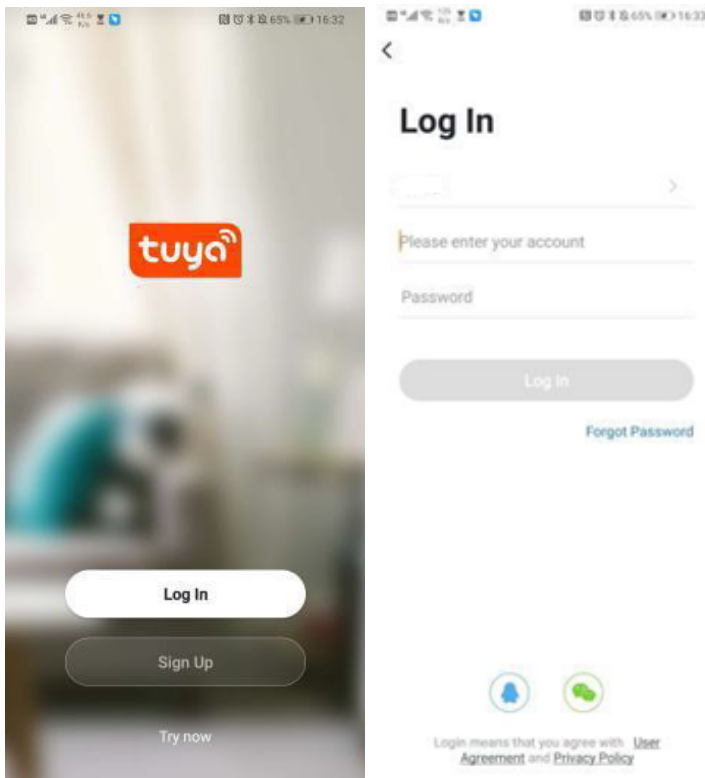

### 3. Add Device on the App:

- Click "All devices" and then choose "Air purifier"
- On the app page, select "small appliance" in the device bar, then choose the Air Purifier.

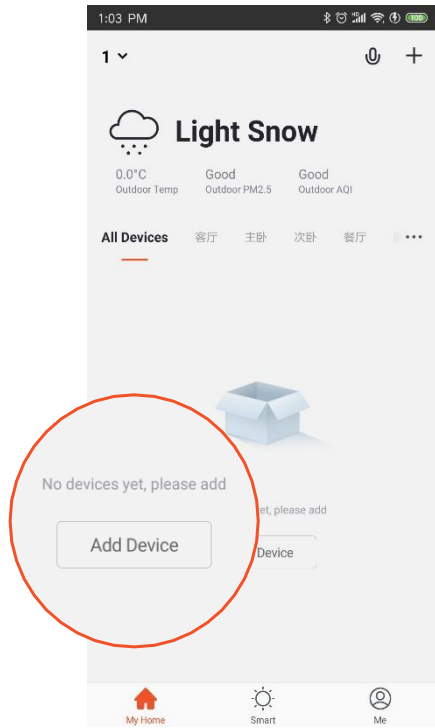

### 4. Click "All devices" and then choose "Air purifier"

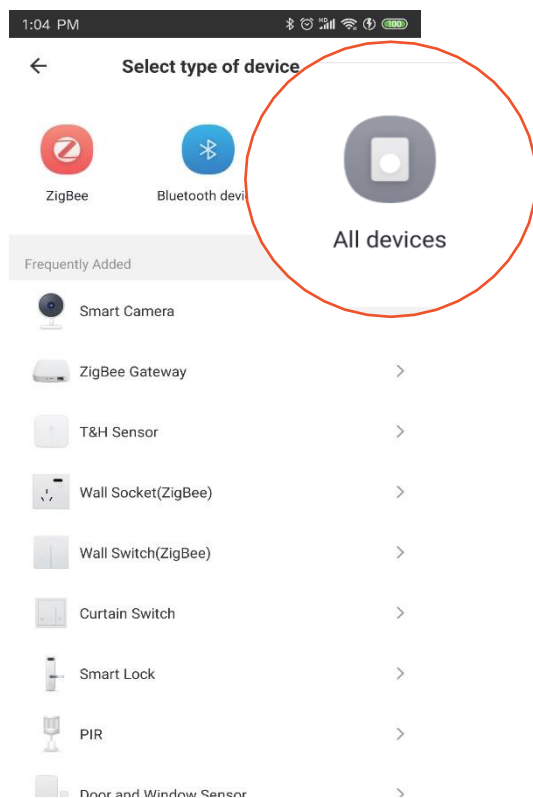

5. **Connect the device** - (switch on the wifi function on the machine, Long press “WiFi” button on machine for 3s, the indicator light will rapidly) click “Finish network configuration”

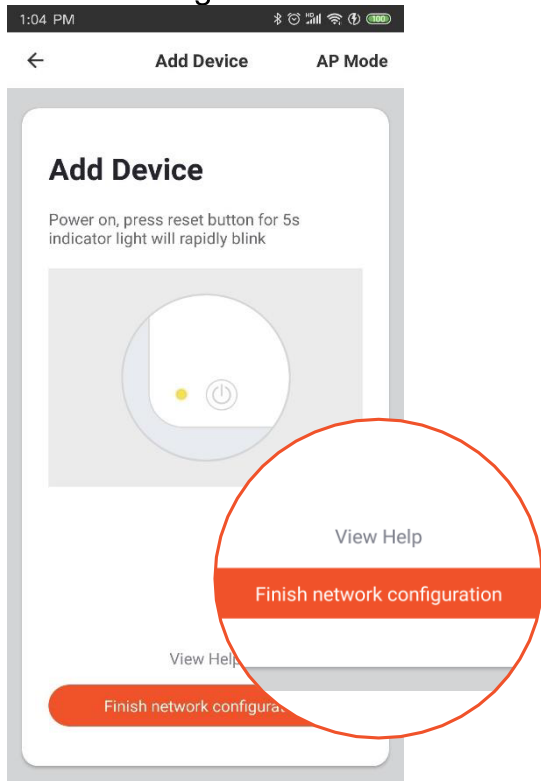

6. Input the wifi account and the password of your home network/room being used in and then confirm

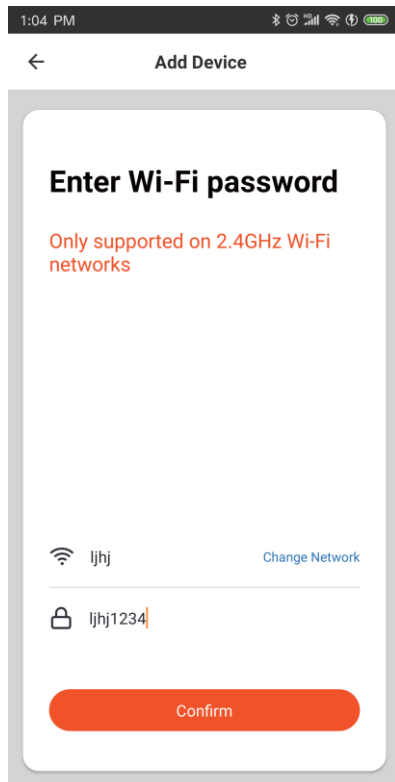

## 7. Connecting

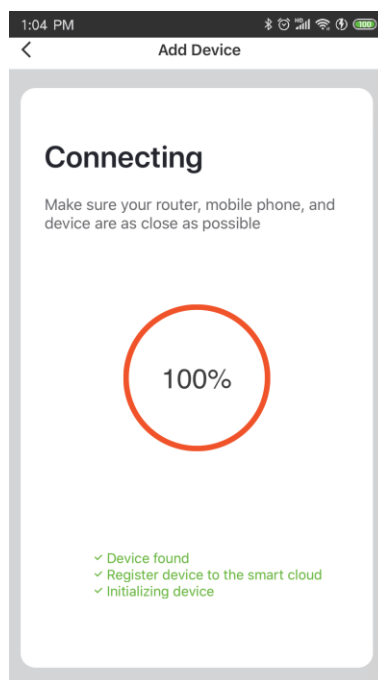
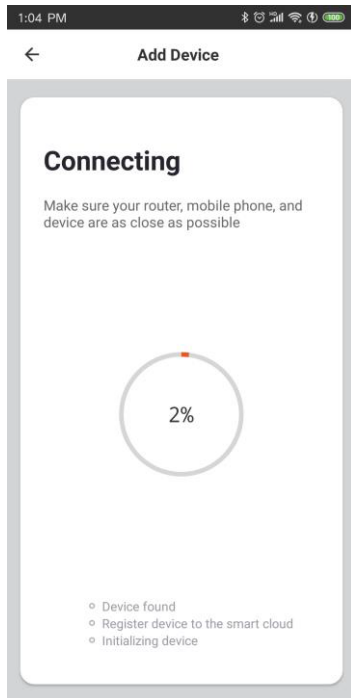

## 8. Device Added Successfully

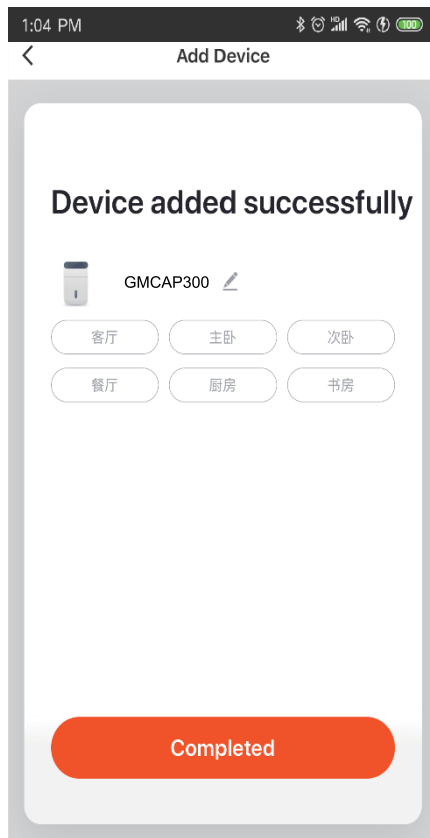

# Maintenance

Always turn off the power and turn off the power to the machine by pressing the button (6) before performing any maintenance operations. You can clean the product body with a slightly damp cloth.

## **Filter change**

Filter changes typically occur every 6 to 12 months, depending on usage and air quality. The unit includes a filter replacement indicator to notify you when it's time.



### **Filter change indicator:**

The filter indicator light is on, indicating that the activated carbon and HEPA composite filter need to be replaced

Note:

- Activated carbon and HEPA composite filters cannot be cleaned or reused. Do not wash them.
- To replace the filter in sequence, please refer to "Before Use". "First-time use of the filter to remove the filter and replace the filter after the filter has expired".

The unit is equipped with a modern filter change indicator.

If the filter has to be checked/replaced, this is indicated by the RESET light flashing on the display.

If the filter has been replaced, the filter change indicator must be reset again. long press the POWER button for 5 seconds to reset the air purifier.

## **Change the filter:**

Switch and disconnect the device for this purpose. Put it upside down and open the filter cover at the bottom of the unit and remove the filter.

Please note that the replacement filter must be removed from the protective film before it can be inserted into the device. Finally, the filter must be locked again.

## **Cleaning the device**

**Always disconnect the power supply from the socket before cleaning!**

Clean the appliance with a dry cloth. Do not use chemicals. You can also clean the air inlets with a vacuum cleaner (it is best to clean the unit outdoors).

### **Attention!**

When your purifier motor stops working, check if you need to replace the filter.

# Specifications

Product name	Air Purifier	Model	GMCAP300
Rated voltage/frequency	220~240V	Product size	290mm(L) x 190mm(W) x 600mm (H)
Power	50W	Net weight	4.9kg
Decibel Rating	28-58dB(A)	Applicable area	50m <sup>2</sup>
CADR	300m <sup>3</sup> /h	Fuselage materials	ABS

## FEATURES

- MODEL: GMCAP300
- 8H timer
- 220~240V/50Hz, 50W
- Air quality indicator: by three-color lights
- Application area: 50m<sup>2</sup>
- CADR: 300m<sup>3</sup>/h
- Child lock
- Filter replacement indicator
- Fan speed: 3 fan speeds, high-med-low
- HEPA13 filter removes 99.97% of particles
- UVC
- Mode: fan speed/sleep mode/auto mode
- Negative ion, ionizer: 10,000,000 pcs/cm<sup>3</sup>
- PM2.5 data display
- Pre-filter, anti-bacteria ion filter, HEPA 13 filter, activated carbon filter (4-stage filter)
- Sensor type: dust sensor
- Touch control LED display panel
- Wifi app control

# TROUBLE SHOOTING

Phenomenon	Reason & Solution
The airflow that comes out of the air outlet is significantly weaker than before.	The surface of the filter is dirty. Clean the surface of the filter (see the cleaning instructions for filter).
The air quality does not improve, even though the appliance has been operating for a long time.	<ul style="list-style-type: none"> <li>• Check if the packing material is removed from the filter.</li> <li>• Make sure that the filter is properly installed.</li> <li>• The air quality sensor is dirty or wet. Clean the air quality sensor</li> <li>• Room size is large or the outdoor air quality is poor. For optimum purification performance, please close the doors and windows when operating the air purifier.</li> <li>• There are indoor pollution resources. For instances, smoking, cooking, incense.</li> <li>• Filter reaches the end of life. Replace the filter with a new one.</li> </ul>
The appliance produces a strange smell.	<p>Please ensure you have removed the plastic over the HEPA filter. The first few times you use the appliance, it may produce a plastic smell. This is normal. However, if the appliance produces a burnt smell even if removing the filter, contact us at <a href="http://www.gmcaircon.com">www.gmcaircon.com</a> or 012-661-1173.</p> <p>The filter may produce smell after being used for a while because of the absorption of indoor gases. It's recommended that you reactivate the filter by putting it in direct sunlight for repeated use. If odor still exists, replace the filter.</p>
Three gear indicator lights up at the same time	There is a machine malfunction. Please cut off the power immediately and contact us on 012-661-1173 or <a href="http://www.gmcaircon.com">www.gmcaircon.com</a>
E1	Please ensure all sensors have been cleaned on the air

	purifier. If the problem still persists please contact us on 012-661-1173 or <a href="http://www.gmcaircon.com">www.gmcaircon.com</a>
The appliance is extra loud.	<ul style="list-style-type: none"> <li>• Check if the packing of the filter is removed.</li> <li>• The appliance will run in high speed when the air quality is poor, which will cause higher noises. When using the appliance in a bedroom at night, choose the Sleep speed.</li> <li>• if anything drops into air outlet, it may also cause abnormal loud sounds. Immediate turn off appliance, turn appliance upside down, to get foreign objectives out of appliance.</li> </ul>
The appliance still indicates that I need to replace a filter, but I already did.	Perhaps you did not reset the filter lifetime counter. Switch on the appliance. If the filter has been replaced, the filter change indicator must be reset again. long press the POWER button for 5 seconds to reset the air purifier.

## SERVICE AND WARRANTY

GMC Airconditioning(Pty) Ltd. was established in 1995 and is one of South Africa's leading cooling and heating companies. We pride ourselves on 100% customer satisfaction and have the highest online rating of all heating and cooling companies in South Africa. We will strive to ensure you are 100% satisfied with your product.

In the rare case of encountering any issues with your product or would like some support please contact us directly on 012-661-1173 or [www.gmcaircon.co.za](http://www.gmcaircon.co.za) as this will allow us to react quickly to your request. If you have bought this product from one of our partner platforms, then contacting us directly will allow us to resolve the issue for you in a timelier fashion.

We are here to help you and ensure you are 100% satisfied.

Please read this instruction manual carefully before setting up or using this product. If you believe this product to be suffering from a manufacturing fault, or if you have any inquiries about this product, please contact our customer support.

### CUSTOMER SUPPORT

#### GMC Airconditioning(Pty) Ltd.

**35 Sarel Baard Crescent  
Gateway Industrial Park  
Centurion  
0046  
Telephone:** +27 (12) 661-1173  
**Website:** [www.gmcaircon.co.za](http://www.gmcaircon.co.za)  
**Email:** [info@gmcaircon.com](mailto:info@gmcaircon.com)

When contacting our customer support, please have the information below available. All warranty requests must be accompanied by a proof of purchase, which is a copy of the original receipt.

**Model:** .....  
**Date of purchase:** .....  
**Purchased from:** .....