



GMC280AP

Air Purifier

USER MANUAL



For enquiries or support: visit www.gmcaircon.co.za or contact us on 012 – 661 1173

***Due to continuous process of product development and improvements the content may vary from that shown in this manual.**

IMPORTANT NOTES

Dear Customer.

Your GMC280AP air purifier has been manufactured in a state-of-the-art facility and has passed the strictest quality control procedures. Please read this manual carefully before using your appliance for the first time and then please store this manual for future reference.

Thank you again for choosing GMC. If you have any issues at all with your product or any questions then the quickest route for resolution is to please contact us through our website www.gmcaircon.co.za or on 012-661-1173. We pride ourselves on 100% customer satisfaction and we trust you will enjoy your new product.

Record in the space below the listed information for future reference.
SERIAL NUMBER
DATE OF PURCHASE
PURCHASED FROM
.....

	Do not attempt to maintain the appliance yourself. Only authorised agents are to carry out repairs.
---	---

CONTENTS

Important Safeguards	1-2
Warning.....	2
Features.....	3
Know Your Air Purifier.....	4
Specifications.....	4
How To Use Your Air Purifier.....	5-6
Cleaning & Maintenance	7
Troubleshooting.....	7

IMPORTANT SAFEGUARDS

WARNING:

RISK OF ELECTRIC SHOCK Safety precautions should always be used when operating this or any electrical appliance. Decrease the risk of electrocution, electric shock, injury or fire by reading and following all the warnings below. Use this product only as described in this manual. To reduce the risk of electric shock, do not attempt to service the product by yourself.

- Read all instructions before operating the GMC air purifier.
- Do not run the power cord under carpets or cover with throw rugs.
- Do not operate the product in a greasy environment such as in the kitchen. This product is not intended to filter oil or grease from air.
- Do not use this GMC air purifier in bathrooms, near sinks or other wet & humid environments, near fireplaces or in areas where flammable or combustible vapors or products may exist.
- Always unplug the power cord from the electrical outlet when the purifier is not in use, before cleaning, inserting or removing parts or before moving to another location.
- Never run the GMC air purifier unless it is fully assembled.
- Always turn off all controls before unplugging this GMC air purifier from outlet.
- Attempting to service this GMC air purifier yourself will void the warranty and could cause serious personal injury to the user and/or result in considerable damage to the unit.
- Do not place the cord near a heated surface.
- Never operate this GMC air purifier if the plug or cord is damaged or appears damaged. Please contact customer care.
- Never use the power cord to pick up, carry, drag, pull or lift the GMC air purifier.
- Do not pull the cord against or around sharp corners and edges. This could result in injury to the user or damage to the cord.
- Always remove the plug from its power outlet by holding onto the plug itself and pulling gently. Never pull on the cord itself to unplug it from its power outlet.
- Use care when operating this air purifier by keeping all foreign objects, fingers and other body parts, hair, loose clothing and jewelry away from openings.
- Never touch this GMC air purifier or its plug when your hands are wet.
- This GMC air purifier is not intended for use for by persons (including children) with reduced physical, sensory or mental capabilities, or lack of experience and knowledge unless they have been given supervision or instruction concerning use of the appliance by a person responsible for their safety.

IMPORTANT SAFEGUARDS

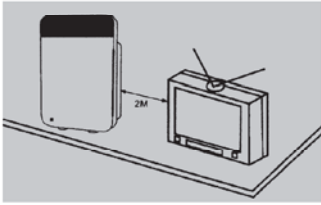

Please keep the machine a distance of 2 meters from the TV, Radio and other electrical appliances.

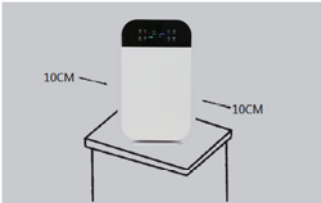

Please keep a distance of 10cm from the wall.

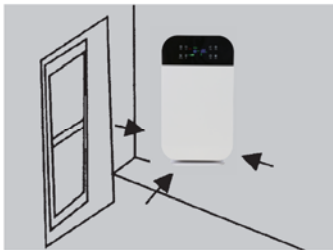

Please place the machine in the room with good air circulation.

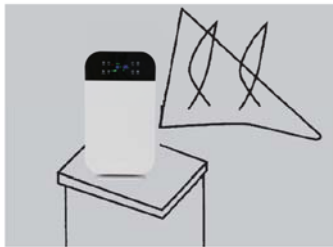

Please do not place the machine near the curtain areas.

WARNING

- a) To avoid electrical shocks DO NOT use wet hands when operating your new air purifier
- b) This machine is equipped with a high-speed rotating motor. DO NOT insert any foreign objects into the machine as this may cause personal injury and damage your air purifier.
- c) It is strictly prohibited to use the Air Purifier in an inflammable or explosive environment. Do not expose the machine to direct sunlight.
- d) It is strictly prohibited to use the machine in a bathroom or high humidity environment as this may cause personal injury through an electrical shock.
- e) Please make sure the power is switched off before cleaning or replacing the filter.
- f) Do not wash or soak any filter or parts of this machine.
- g) The combined filter is not washable but replacement filters are available through www.gmcaircon.co.za

FEATURES

- **Pre-Filter** - Traps larger dust particles and can be washed and re-used.
- **HEPA Filter** - Removes particles as small as 0.3 microns from the air at 99% effectiveness.
- **High Quality Active Carbon Filter** removes VOCs (Volatile Organic Compounds) and controls odors.
- **Cold catalyst Filter** - the cold catalyst filter is used to decompose odors in the air such as formaldehyde, alcohol and ammonia, and kill viruses and bacteria in the air too.
- **UV Bulb Sterilization** - the germicidal UV bulb is used for bacteria control.
- **Built-in Ionizer** Releases the proper concentration of negative ions to keep the air fresh.
- Effectively removes smoke, pollen, dust, animal dander, dust mites from the air.
- Powerful and quiet fan has 3 speed settings so you can select the desired cleaning level.
- **Air Quality Indicator** shows current air quality.
- **PM 2.5 Display** - PM2.5 It detects the concentration of dust
 - PM2.5 indicates detected particulate matter is <2.5 μm in diameter
 - AQI number indicates dust particulate matter concentration within a range of 0 $\mu\text{g}/\text{m}^3$ to 1,000 $\mu\text{g}/\text{m}^3$
- **Smart Auto Mode** automatically adjusts fan speed depending on air quality.
- **ON/OFF Timer** - 8 hour timer to set the time of operation, from 1 hour up to 8 hours.
- **Sleep Mode** dims the control panel light when you sleep.
- **Filter Replacement Indicator** - notifies you when it is time to replace the filters.
- **Digital Display** - displays the current operation of the unit.
- **Soft touch Button Control** - sensitive soft touch buttons, easy to operate.
- **Low power consumption**-energy efficient.
- Easy operation with **Remote Control**.

KNOW YOUR AIR PURIFIER

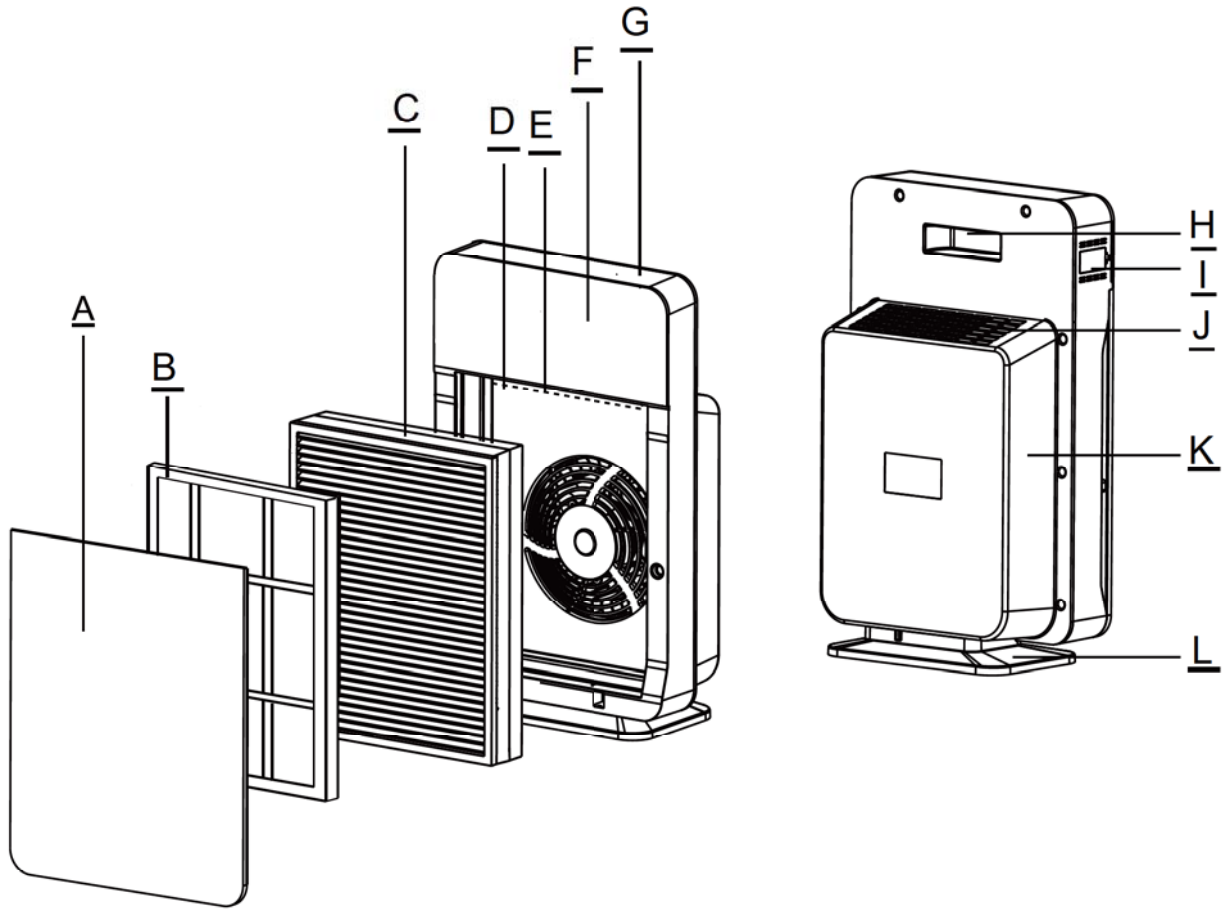

A: Front cover

B: Washable prefilter

C: Pre-filter & HEPA &
& Active carbon filter
& cold catalyst

D: UV light

E: ION

F: Control and Display panel

G: Main body

H: Handle

I: Sensor

J: Outlet

K: Rear cover

L: Base

SPECIFICATIONS

Model No	GMC280AP
Voltage/ Frequency	220V-240V AC ,50Hz / 60Hz
Power	50W
CADR	280 m ³ /h

For enquiries or support: visit www.gmcaircon.co.za or contact us on 012 – 661 1173

HOW TO USE YOUR AIR PURIFIER

Before first use, remove filters and remove plastic bag from filters, then reinstall filters. Then reinstall front cover.

Plug the unit into an electrical outlet. The unit will be ready to run. Read the following directions to select desired settings.

AIR QUALITY MONITOR/ PM DISPLAY

Your new GMC Air Purifier is equipped with an air quality monitor that continuously monitors the quality of the air within the environment. The Air quality monitor will display 3 different air quality types on the LED panel – indicating the quality of your air in the room.

GREEN = Good Air Quality

ORANGE = Moderate Air Quality

RED = Poor Air Quality

You can choose to set the purifier to “Smart Auto”. This will enable the purifier to adjust the fan speed according to the air quality. In Smart Auto mode, the fan speed will be adjusted as follows:

Good Air Quality = Low Fan Speed

Moderate Air Quality = Medium Fan Speed

Poor Air Quality = High Fan Speed

Control Panel

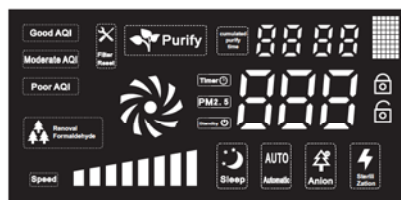

1. Power

As soon as you press the power button, the purifier will start in the Auto mode.

2. Auto

As soon as the auto program has been activated it will start up in a pre program speed, the sensor will start to detect the amount of particulate in the air. As the particles are detected, the air purifier will

For enquiries or support: visit www.gmcaircon.co.za or contact us on 012 – 661 1173

HOW TO USE YOUR AIR PURIFIER

select the purification speed (fan speed) that is appropriate to the particulate contamination in the room.

3. Speed

Press speed button to control the speed from 1 to 4 when it is under Normal mode or Auto mode.

4. ION

Press button to turn on/off the ION function Normal or Auto mode.

5. Lock

Press lock button, other buttons cannot be used. Long press of 5s to unlock it.

6. Sleep

When the machine enters sleep mode the display will dim and not be as bright.

Press the 'SLEEP' or the 'SPEED' button to exit the sleep mode.

7. Timer

Press Timer button repeatedly to set Timer. 1-10hour can be set under any mode.

Press to reset the time when the replace filter be red.

8. STERILIZE

Press to turn on/off the UV light.

9. Remote Controller

Press the buttons for the respective function

10. Filter Reset

The lifetime of your Air purifier filter is +/- 3000 working hours. The filter reset light will display 'Red' when this amount has been reached, this indicates you need to replace the filter. Once you have replaced the filter, please press and hold down the 'timer' button for 3 seconds and this will set the filter 'lifetime counter' to 0.

CLEANING & MAINTENANCE

Use a soft cloth to clean the outer surface of your Air purifier

Please do not immerse the Air purifier in water or any other liquid for cleaning.

CLEANING THE PRE-FILTER

- a) Ensure that the unit is switched off and unplugged.
- b) Ensure the front of the unit is facing you, pull the lid towards you at the upper end and remove the front cover.
- c) Gently remove the re-usable pre-filter from the side of the combined filter.
- d) To clean the pre-filter simply submerge in warm soapy water. Gently lift and submerge the pre-filter several times until it is clean.
- e) Rinse the pre-filter with clean water and allow it to dry out completely before placing it back onto the front side of the combined filter.

CLEANING THE DUST SENSOR

The GMC air purifier is designed with an dust sensor to track the quality of your air. Over time the sensor can become dirty and may require cleaning. In order to clean the dust sensor you must use a vacuum to clear the monitor chamber.

- Power off and unplug unit.
- Locate and open the dust sensor panel door located on the side of the unit.
- Use a vacuum cleaner hose to suction any dust or dirt that may have accumulated inside the chamber.

REPLACING THE COMBINE FILTERS

- Make sure the unit is turned off and unplugged. With the front of the unit facing forward, pull the lid towards you at the upper end and remove the front cover.
- Remove the combine filters by lifting and pulling the tabs on both sides of the filters.
- Insert new combine filters and then snap the lower part of the front cover back into position.
- To close the front cover, first make sure the bottom hooks are properly in place before snapping it up to its upright and locked position.

TROUBLESHOOTING

PROBLEM	REASON	SOLUTION
Unit won't operate.	ON/OFF button hasn't been pressed.	Press ON/OFF button.
	Unit is unplugged.	Plug in unit.
Reduced air flow or poor filtering.	The inlet or outlet grill may be blocked.	Ensure nothing is in front of or on top of the purifier.
	The pre filter may be clogged.	Check filters and replace it if necessary.
	Filters may still be in bags	Remove filters from bags.
The AUTO mode is not activating the ION mode.	The AUTO mode is designed to adjust the fan speed depending on the air quality. Other modes must be activated separately	The unit is operating normally, no action required

For enquiries or support: visit www.gmcaircon.co.za or contact us on 012 – 661 1173

SERVICE AND WARRANTY

GMC Airconditioning CC was established in 1995 and is one of South Africa’s leading cooling and heating companies. We pride ourselves on 100% customer satisfaction and have the highest online rating of all heating and cooling companies. We will strive to ensure you are 100% satisfied with your product.

In the rare case of encountering any issues with your product or would like some support please contact us directly on 012-661-1773 or www.gmcaircon.co.za as this will allow us to react quickly to your request. If you have bought this product from one of our partner platforms contacting us directly will allow us to resolve the issue for you in a timelier fashion. We are here to help you and ensure you are 100% satisfied.

Please read the Instruction Manual carefully before setting up or using this product. If you believe this product to be suffering from a manufacturing fault, or if you have inquiries about this product, please contact our Customer Support:

CUSTOMER SUPPORT

GMC Airconditioning CC

35 Sarel Baard Crescent Gateway Industrial Park Centurion 0046

Telephone : +27 (12) 661 - 1173

Website: www.gmcaircon.co.za

Email : info@gmcaircon.com

When contacting our Customer Support, please have the information below along with the proof of purchase. All warranty requests must be accompanied by a proof of purchase, which is a copy of the original receipt.

Model :

Date of purchase:

Purchased from :